

- When wireless microphone battery is dead, you can twist the microphone to the left, and replace the AA battery. Please pay attention to the positive and negative poles when replacing the battery.
- Howling: Please do not put the microphone close to the speaker device. Please try to put the microphone a little bit away from or the back of the speaker device, or try to turn down the volume of microphone.
- Low microphone volume/No microphone volume: Please make sure the microphone volume is turned up to the maximum.

#### Troubleshooting

- Automatically shut down when turned on**  
The battery is low, please fully charge it before use.
- The player automatically shuts down or restarts**  
The battery is low, please fully charge it before use.
- The charging light is not on, not charging**  
Please make sure the charging cable is plugged in properly and whether it is damaged or normal, please use a 5V-2A charger to charge the device.
- Bluetooth status is silent**  
Please make sure the Bluetooth is paired correctly, and the Bluetooth device is playing, and the volume is not at the minimum.
- TF card/U disk playback is silent**  
Check whether the TF card is inserted in the correct direction and in place, whether the U disk is inserted in place or in good contact; whether the music format in the TF card or U disk is correct (Note: The music in the TF card/U disk mainly supports MP3 compressed audio files and WMA lossless audio files playback); whether the device volume is adjusted to the minimum.

- Recording doesn't work**  
Whether there is space in the TF card or U disk, delete some files to reserve storage space. Recording should be in TF card mode, U disk mode and insert a wired microphone or turn on a wireless microphone.
- The recording cannot be deleted**  
Please long press the record button or connect to a computer to delete it when playing the recording file.
- The recording sound is low or there is noise**  
Insert a wired microphone or turn on a wireless microphone when recording.
- Power saving mode, automatic shutdown**  
In the state of Bluetooth mode, the speaker is not connected to any Bluetooth device, and there is no operation for 15 minutes, the speaker will enter the power saving mode and automatically shut down.

#### Specifications:

Input voltage:	5V = 2A
Output Power:	80W RMS
Frequency effect:	80Hz—12KHz
S/N:	≥ 80dB
FM frequency:	87.5-108MHz
Battery:	6000mAh
Product size:	264x283x329mm

#### Inside the box:

- 1 x Bluetooth Speaker
- 1 x Charging Cable
- 1 x AUX Cable
- 1 x User Manual
- 1 x Remote Control
- 1 x Wireless UHF Mic
- 1 x Warranty Card

**ARTIS**

For Speaker  
IS 616:2017/  
IEC 60065:2014



R-41281930  
www.bis.gov.in

For Mic  
IS 616:2017/  
IEC 60065:2014



R-41186856  
www.bis.gov.in

Website: www.artis.in  
Customer care: 1800 123 8195  
Email: inquiry@artis.in



Scan this QR Code to explore Artis products

**ARTIS**

**80W**  
RMS

**UHF**  
Mic

**RGB**  
LED Lights



**SoundPro 110**  
Wireless BT Party Speaker

**USER MANUAL**

## SoundPro 110 Bluetooth Party Speaker

Please read this user manual carefully before operating the speaker

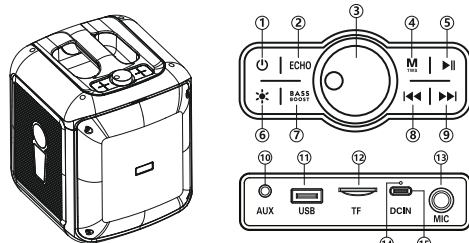

#### Product Features

- Long press to power on/off. (Press and hold for 10 seconds to restore factory settings)
- ECHO**: Short press switch to the effect of echo of microphone.
- VOLUME**: Turn left to decrease volume, turn right to increase volume.
- M** Short press mode conversion: Bluetooth, FM, AUX, U disk, TF card. Long press for TWS function.
- ▶||** Short press to play/pause. While in Bluetooth mode, long press will disconnect with other devices. While in FM radio mode, long press to automatically search for channel in FM mode.
- ★** Short press to turn on the ambient light, long press to directly turn off the ambient light.
- BASS** Short press can enhance the bass effect.
- ◀◀** Short press to previous song/select the previous radio station. In the state of U disk or TF card, long press to rewind the song.

- ▶▶ Short press to next song/select the next radio station. In the state of U disk or TF card, long press to fast forward the song.
- AUX**: AUX audio input.
- USB**: Insert the U disk to play MP3 music. (Max workable capacity for USB is 64 GB, if more than 64 GB it can not work.)
- TF**: Insert TF card to play MP3 music. (Max workable capacity for TF Card is 64 GB, if more than 64 GB it can not work.)
- MIC**: Plug in a wired microphone and singing a song.
- Charging Indicator**: The red light is on when charging, the red light is off when fully charged.
- DCIN**: Charging jack, use a USB charging cable to connect with the charger for charging.

#### Bluetooth Connectivity

Turn on to enter the Bluetooth mode. Then turn on the mobile Bluetooth and search the Bluetooth name of the speaker or find a string of digital code for pairing. If there is a prompt to pair the password, please enter "0000" and click confirm connection.

#### TWS Pairing

- In bluetooth mode, turn on the two bluetooth speaker device at the same time, and then turn on any speaker and long press **M** key to pair with another speaker to connect, long press again to disconnect TWS.
- The optimal connection distance between two Bluetooth speakers is about 5 meters

#### Charging Instruction

- To protect the performance of the battery, avoid using the machine while charging.
- Note: The machine has no power bank function, it is forbidden to connect other devices through the USB interface.
- Use a 5V = 2A charger connected with usb charging cable for the device to charge, the red light is on when charging, and the red light is off when fully charged.

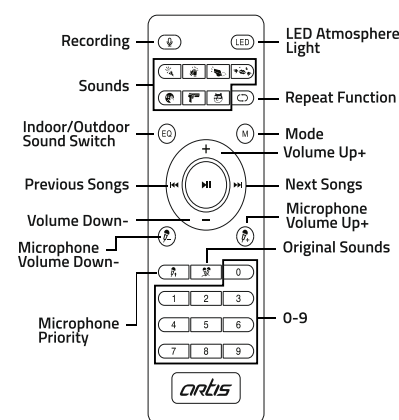

#### Remote Schematic diagram and operation instructions

- Under normal circumstances, the remote control should be used within the receiving range of about 6 meters and 30 degrees from the device receiving window.
- When operating the remote, please aim it at the receiving window of the device. There should be no obstacles between the remote and the device.
- If the receiving window of the device is placed under a strong light, the operation panel of the remote may malfunction. In this case, please move the device away to avoid direct exposure.
- When the remote no battery, you can replace the battery to avoid mixing old and new batteries. Please check the remote batteries regularly to see if they need to be replaced.

#### Wireless Microphone Operation

- Long press to power ON/OFF.
- When the microphone is not connected to the device, the display will flicker slowly. When the microphone is successfully connected to the device, the display screen will stop flashing and display a steady state. The display blinks quickly when the battery is low.

